



BEUMER
technology in motion

CONVEYING TECHNOLOGY
LOADING TECHNOLOGY
PALLETIZING TECHNOLOGY
PACKAGING TECHNOLOGY
SORTATION AND
DISTRIBUTION SYSTEMS



PRODUCT INFORMATION
BEUMER paletpac® 1500



BEUMER
technology in motion

BEUMER paletpac® 1500



The BEUMER palletizer line, known as the BEUMER paletpac® series, is widely recognized as a leading palletizer design by a broad spectrum of industries. Constant research and consistent improvements of the BEUMER paletpac® systems have resulted in highly reliable machines that yield exceptionally stable stacks. The BEUMER paletpac® is adaptable to a wide range of applications and offers the ideal solution for any requirement.

Our product line of load securing equipment complements our palletizing and loading systems for shipping applications.



From the packing to the load-out stage, BEUMER can supply the complete system, including superior engineering and reliable service, from one source.



Take advantage of the vast experience of BEUMER gained from the supply of hundreds of palletizing systems.

The **BEUMER paletpac® 1500** is the ideal machine for intermediate capacities from 1000 to 1500 bags per hour. This palletizer can handle paper as well as PE and PP bags and is the preferred machine for handling salt, fertilizer and chemical products (e.g. PE, PP and ABS granulate) due to its special design utilizing an overhead clamp bag turning device.

The conception of the **BEUMER paletpac® 1500** is the result of many years of experience in the design of equipment to handle products that are difficult to palletize.

Our know-how guarantees the optimum machine to the user. The standard equipment can be provided with options that will consider all the technical and functional requirements of the user.

The **BEUMER paletpac® 1500** offers the following advantages:

- adaptable to all conventional packing patterns

- extremely careful bag handling
- low noise level and low degree of wear due to advanced technology
- ease of operation and advanced system diagnostics
- quick adjustment of parameters for the adaptation of variable bag and pallet dimensions

The **BEUMER paletpac® 1500** has proven itself in many of the plants of the multi-national chemical companies around the world.

BEUMER paletpac® – the palletizer for the demanding customer

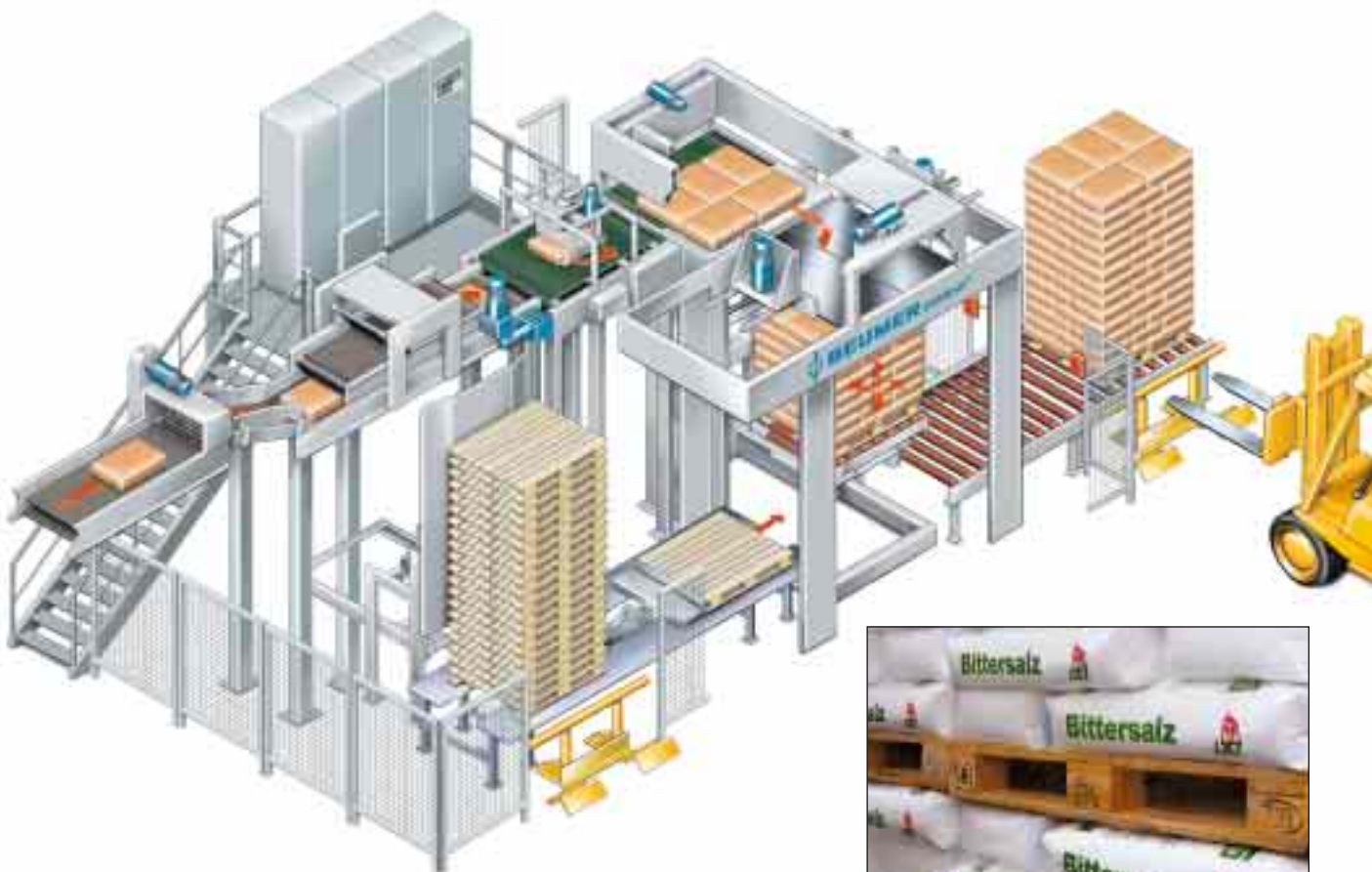

TECHNICAL INFORMATION

Basic dimensions

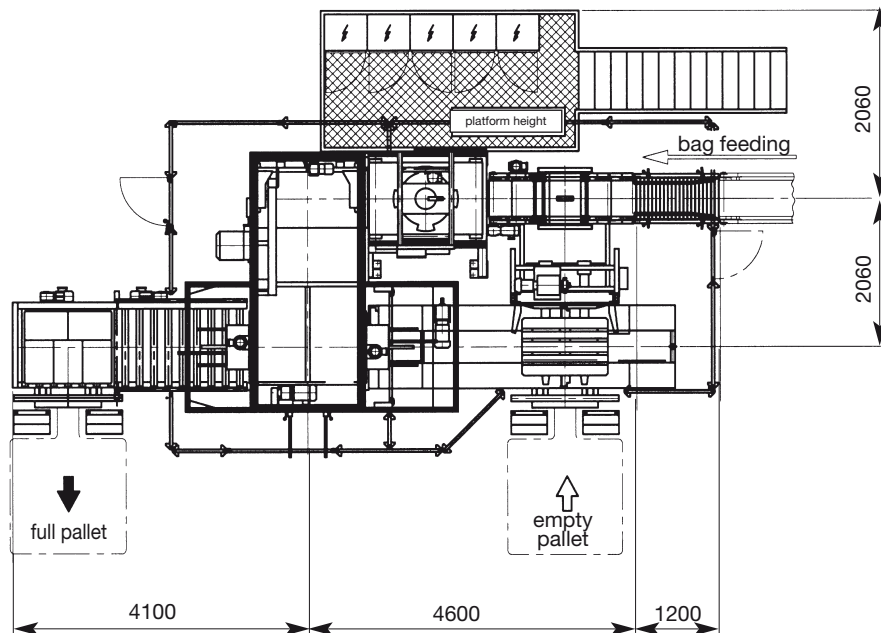
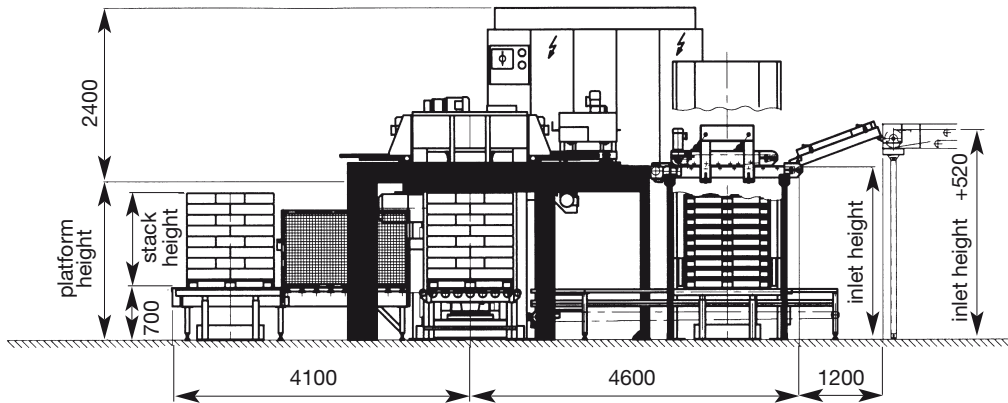

stack height	inlet height	number of empty pallets	platform height
1400	2400	20	2200
1600	2600	20	2400
1800	2800	20	2600
2100	3100	20	3000

We reserve the right to make changes without notification.

00-00-GB-00/00

BEUMER Maschinenfabrik GmbH & Co. KG

Postfach 1254 · D - 59267 Beckum · Tel. +49 - (0) 25 21 - 24 0 · Fax +49 - (0) 25 21 - 24 280
E-Mail: BEUMER@BEUMER.com · Internet: www.BEUMER.com

BEUMER Corporation
Bridgewater, NJ/USA
Phone: +1 7325608222
Fax: +1 7325630905

BEUMER S.a.r.l.
St. Ouen L'Aumone/France
Phone: +33 (0) 134642520
Fax: +33 (0) 130376883

BEUMER Ltda.
Campinas - SP/Brazil
Phone: +55 (0) 1932431700
Fax: +55 (0) 1932421411

Australian Representative Office of BEUMER
Adelaide/South Australia
Phone: +61 (0) 883568565, Fax: +61 (0) 883568705

Asian Representative Office of BEUMER
Bangkok/Thailand
Phone: +66 (0) 27317190, Fax: +66 (0) 27317194